



Limotec

Perfection in Detection



LX0921WW-TF-V01-EN

ROLP LX WALL WHITE FLASH IN WHITE HOUSING – IP65 - Art. LX0921WW -

DATASHEET



- ROSHNI RoLP white sounder not included and to be provided separately
- For wall mounting up to a maximum height of 2.4 metres
- Dimensions (H x W x D): 134 x 96 x 96 mm
- Supply voltage: 18 – 28Vdc
- Current: maximum 25mA (excluding sounder current)
- Coverage: 7,5m of 135m³ (High Power Mode)
- Flash rate: 1Hz (High Power Mode)
- Polarity: dependant
- Operating temperature: -25°C tot +70°



SUITABLE FOR :

| MD2400SA | MD2400L | MD2400 | MD644 | MD300 |



EN54-13 CERTIFICATE

MD2400/MD2400L: B-9072-FD-954

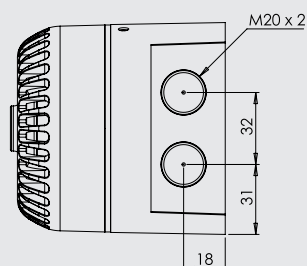
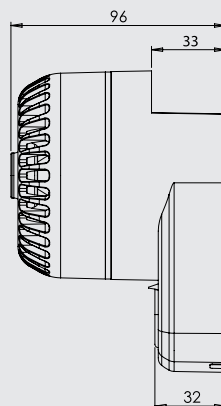
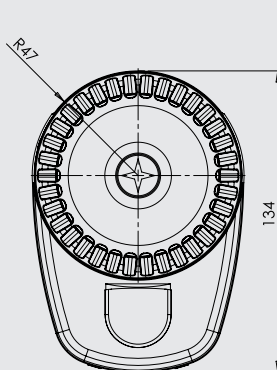

Changes can be made without prior notice

Limotec nv
Bosstraat 21, B-8570 Vichte
www.limotec.be



A Halma company - Infrastructure Safety

